

Size range: 1¼" - 4"



Fitpro® is a coupling designed to make fast rigid connections in both dry and wet sprinkler piping systems. It is used with grooved piping only and it is ready for installation. **Patented design.**

### GENERAL INFO - BEFORE YOU START

- Installers should be trained or experienced to install and understand the product.
- Before installation, carefully check the product on any damage during shipment or handling.
- Read and understand all technical datasheets and installation instructions before attempting to install, remove or adjust any Profit products.
- Check if the pressure rating of the product is compatible with the service conditions.
- Depressurise and drain the sprinkler installation system before attempting to install, remove or adjust any Profit products.
- Never work on piping-systems that are pressurised and/or filled with water or pressurised air.
- Use the necessary Personal Protection Equipment (PPE) to avoid personal injury (helmet, safety shoes, goggles and gloves).



- Use appropriate tooling:
  - Profit groove meter.
  - Impact-wrench and torque-wrench.
  - Correct socket size and depth.
- Bolt specifications:

Coupling	Boltsize	Socket size	Minimum socket depth	Recomended bolt torque	Maximum allowed bolt torque
1¼", 1½", 2", 2½", 3"	M10	17 mm	35 mm	55 Nm	75 Nm
4"	M12	22 mm	40 mm	100 Nm	110 Nm

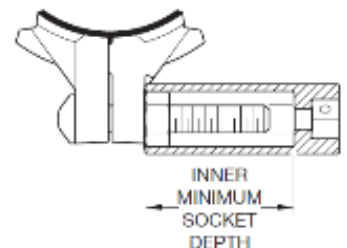

Tighten further where needed, but do not exceed the maximum allowed bolt torques. If the bolt torque does exceed the maximum allowable torque, check the groove dimensions.  
(C groove diameter & F maximum outspread)

Installation is intended for rolled and cut grooved pipe systems according to AWWA C606.  
We refer to the tables below for the rolled and cut groove dimensions.

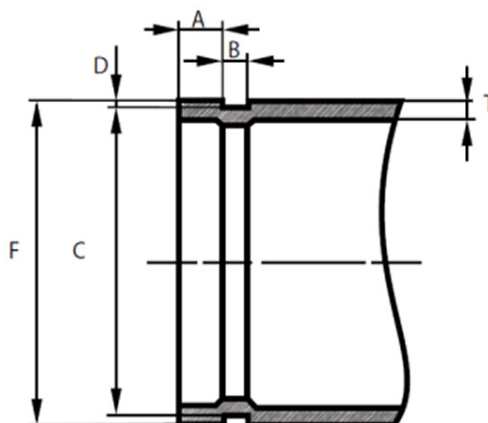

### Rolled groove dimensions

Nominal pipe size		Outside diameter			Gasket seat A	Groove width B	Groove diameter C		Groove depth D	Maximum outspread F
NPS (DN)	Size	mm	+ mm	- mm	Tolerance +0,4 / -0,8 mm	Tolerance +0,4 / -0,8 mm	Size	Tolerance mm	mm	mm
1¼	32	42,4	0,41	0,41	15,9	7,1	39,0	+0/-0,4	1,6	43,3
1½	40	48,3	0,48	0,48	15,9	7,1	45,1	+0/-0,4	1,6	49,4
2	50	60,3	0,61	0,61	15,9	8,7	57,2	+0/-0,4	1,6	62,2
2½	65	76,1	0,76	0,76	15,9	8,7	72,3	+0/-0,4	2,0	77,7
3	80	88,9	0,89	0,79	15,9	8,7	84,9	+0/-0,4	2,0	90,6
4	100	114,3	1,14	0,79	15,9	8,7	110,1	+0/-0,5	2,2	116,2

### Cut groove dimensions

Nominal pipe size		Outside diameter OD			Gasket seat A	Groove width B	Groove diameter C		Groove depth D	Minimum thickness T
NPS (DN)	Size	mm	+ mm	- mm	Tolerance +0,8 / -0,8 mm	Tolerance +0,8 / -0,8 mm	Size	Tolerance mm	mm	mm
1¼	32	42,4	0,41	0,41	15,9	7,9	39,0	+0/-0,4	1,6	3,6
1½	40	48,3	0,48	0,48	15,9	7,9	45,1	+0/-0,4	1,6	3,7
2	50	60,3	0,61	0,61	15,9	7,9	57,2	+0/-0,4	1,6	3,9
2½	65	76,1	0,76	0,76	15,9	7,9	72,3	+0/-0,4	2,0	4,8
3	80	88,9	0,89	0,79	15,9	7,9	84,9	+0/-0,4	2,0	4,8
4	100	114,3	1,14	0,79	15,9	9,5	110,1	+0/-0,5	2,2	5,2

Painted pipe requirements: if any painting damages are observed on the pipe end (position for the gasket seal), all paint needs to be removed to avoid leakage.

- Check that the coupling is complete. Every Profit Fitpro® coupling consists of 2 cast iron housings [1], 1 self-lubricating gasket [5], 2 T-bolts [4], 2 R-spacers [3] and 2 heavy hex nuts [2]. Please verify that the T-bolts and R-spacer are in the correct position as shown in the image on the right.

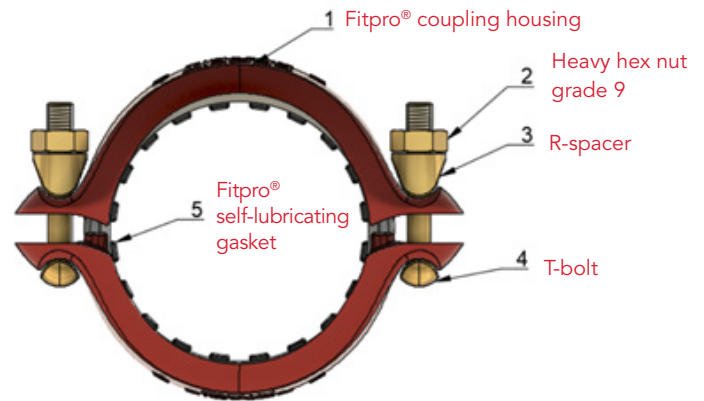

- Please verify that the T-bolts and the R-spacer are in the correct position with the spherical part mating the housing-shape.

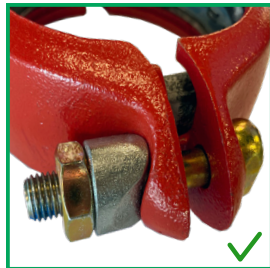
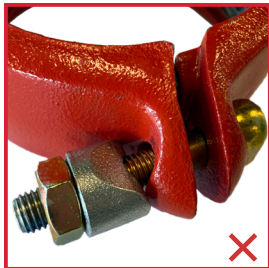

- Please verify that the tongue-and-recess feature is mating up properly.

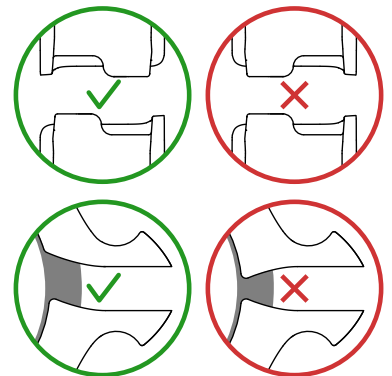
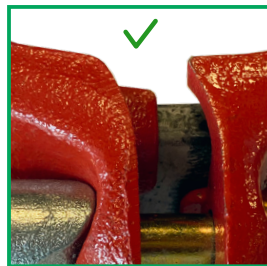
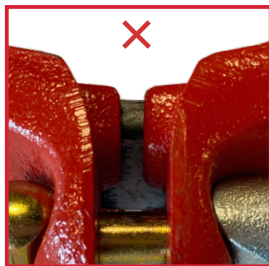
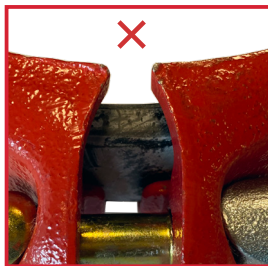

- Do not dis-assemble Fitpro® couplings prior to installation, Fitpro® is ready for installation.
- We advise to always store our products in closed and dry environments, the products do not need any specific maintenance once installed on an aboveground sprinkler installation.
- Please lubricate the gasket sealing lips or pipe end with Profit lubricant in any of following conditions:
  - Dry pipe systems;
  - Wet system which will be subject of a pneumatic test;
  - If the gasket was exposed to fluids before installation;
  - If the pre-lubrication coating of the gasket has been removed.
- In case lubrication is required, only apply a thin layer of Profit lubricant.
- Failure to follow these instructions could result in property damage, serious injury or death.

## FIRST INSTALLATION

### 1. Verify

Verify the pipe, groove and outspread dimensions are in accordance with Profit roll and cut groove dimensions (tables page 2) and free of oil, dirt, loose paint, indentations and burrs.

It is important to have a clean and cylindrical gasket-sealing surface to guarantee a good fit.

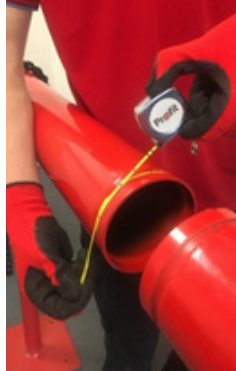

### 2. Fit one side on the pipe

Push the coupling on the first pipe or component by inserting the pipe into the gasket until it is stopped by the gasket intermittent center-stops. Do not leave the coupling unattended on one pipe end, there is always the risk of coupling drop causing injury or damage. Lubrication is not required unless mounted in the specific conditions defined on page 3.

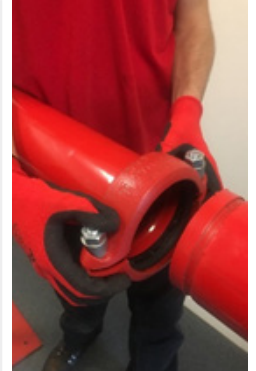

### 3. Fit the other pipe

Insert the other component until you hit the 'center-stop'. Make sure that both pipes or components are well aligned to each other vertically and horizontally. Check now that both housing keys are aligned with the grooves in the pipes (both sides).

Prior to closing the bolts, the coupling should be partially rotated to verify the gasket is properly positioned.



### 4. Torque the nuts

Tighten the two nuts evenly alternating (2 - 3 times) until you reach metal-to-metal contact of outer ends of the bolt-pads.

Tighten now the nuts to the recommended torque (tables page 1) with a torque wrench.

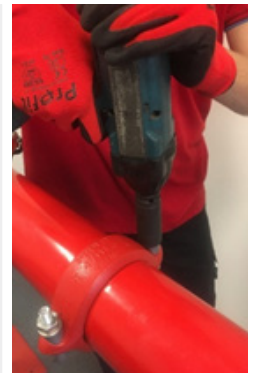

### 5. Check

Check both sides of both bolt-pads: the pads should make metal-to-metal contact leaving no gap at the bolt-position. Tighten further where needed, but do not exceed the maximum allowed bolt torque.

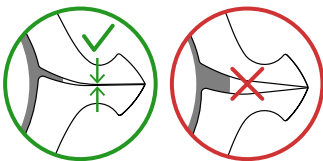

### Installation video

Watch our installation video on the Fitpro® page of our website or scan the QR code on the right.



## RETROFIT INSTALLATION

### 1. Verify

Verify the pipe, groove- and outspread dimensions are in accordance with Profit roll and cut groove dimensions (tables page 2) and free of oil, dirt, loose paint, indentations and burrs.

It is important to have a clean and cylindrical gasket-sealing surface to guarantee a good fit. Disassemble the previously installed Fitpro® and check for any damage or wear. If any damage or wear is present, use a new Profit Fitpro® coupling.

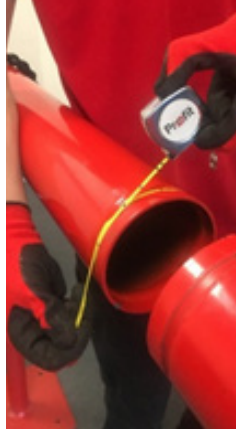

### 2. Lubricate

Remove the gasket from the coupling. Lubricate the gasket sealing lips or pipe end and the coupling housing inside. Re-assemble the coupling.

### 3. Fit one side on the pipe

Push the coupling on the first pipe or component by inserting the pipe into the gasket until it is stopped by the gasket intermittent center-stops. Do not leave the coupling unattended on one pipe end, there is always the risk of coupling drop causing injury or damage.

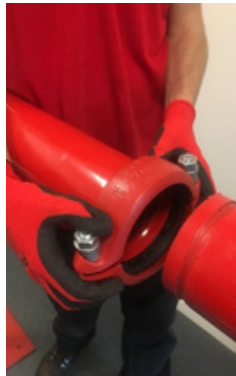

### 4. Fit the other pipe

Insert the other component until you hit the 'center-stop'. Make sure that both pipes or components are well aligned to each other vertically and horizontally. Check now that both housing keys are aligned with the grooves in the pipes (both sides). Prior to closing the bolts, the coupling should be partially rotated to verify the gasket is properly positioned.

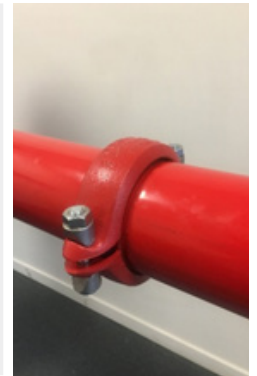

### 5. Torque the nuts

Tighten the two nuts evenly alternating (2 - 3 times) until you reach metal-to-metal contact of outer ends of the bolt-pads.

Tighten now the nuts to the recommended torque (tables page 1) with a torque wrench.



### 6. Check

Check both sides of both bolt-pads: the pads should make metal-to-metal contact leaving no gap at the bolt-position. Tighten further where needed, but do not exceed the maximum allowed bolt torque.

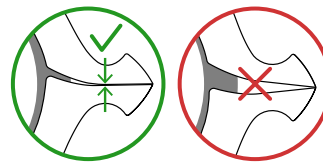

## REVISION TABLE

Date	△	Notes
08/05/2026		New design.